

MX Deck Rail 6675-XXXX Installation and Technical Guide

August 11, 2009 2:08 PM

**This Installation Guide
must NOT be removed
from the Deck Rail**

MX Deck Rail - Installation Guide

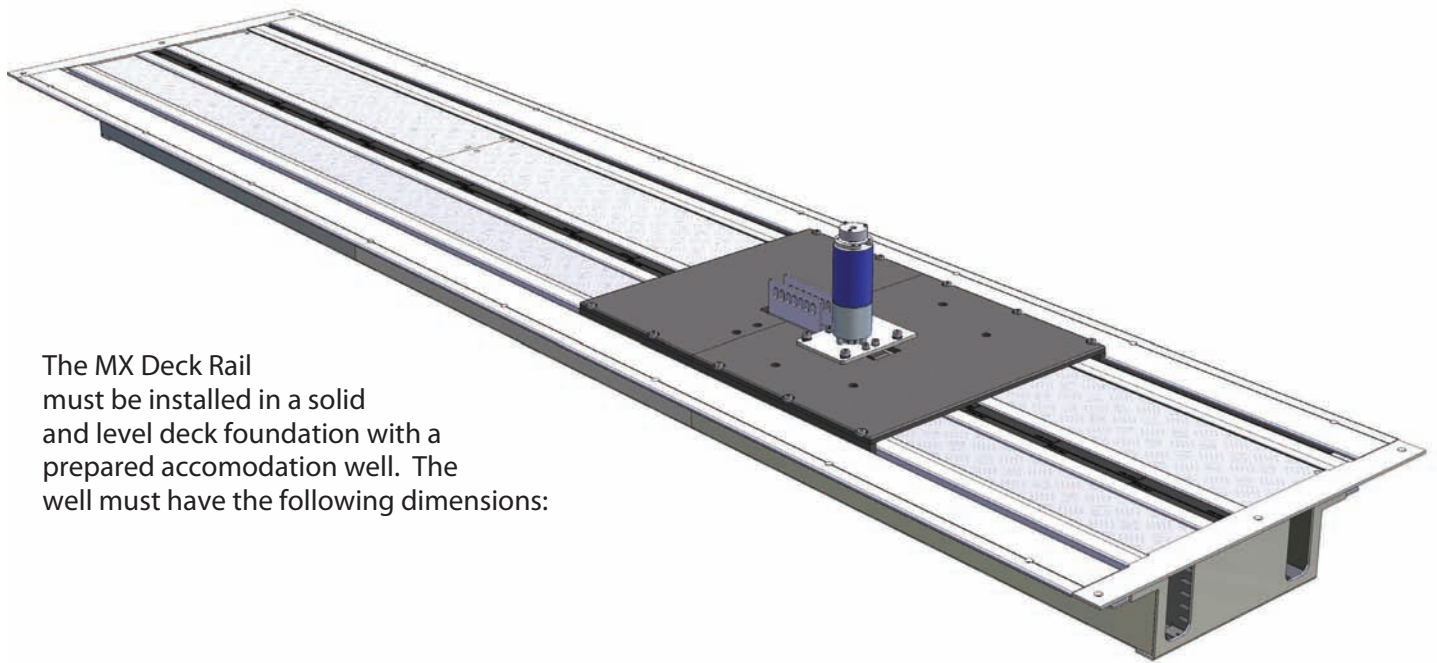

The MX Deck Rail must be installed in a solid and level deck foundation with a prepared accomodation well. The well must have the following dimensions:

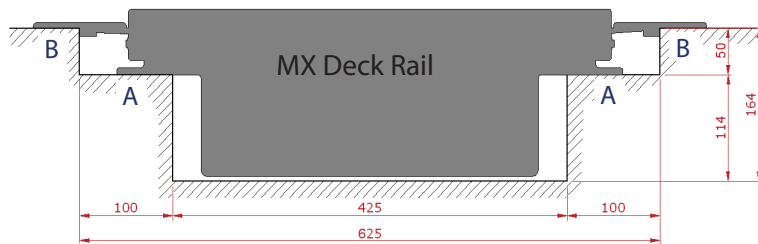

Width : 625mm
 Length : Deck-Rail length (L) + 10mm
 Depth : 164mm.

Hole patterns for mounting the deck rail and the flush trim set must be prepared in the deck and well. The hole pattern for the deck rail is marked "A" and the hole pattern for the flush trim set is marked "B".

Accomodation Well.

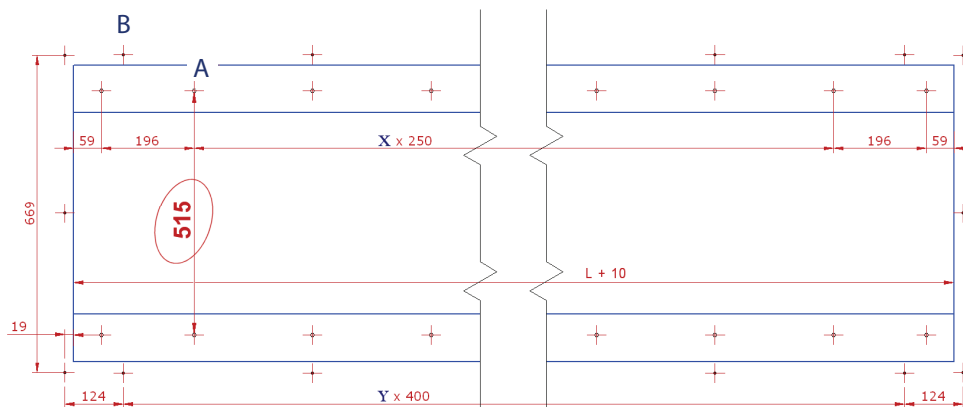

IMPORTANT NOTE ! It is essential that the width dimension for the deck rail hole pattern (515mm) be absolutely accurate along its entire length to avoid binding.

MX Deck Rail - Installation Guide

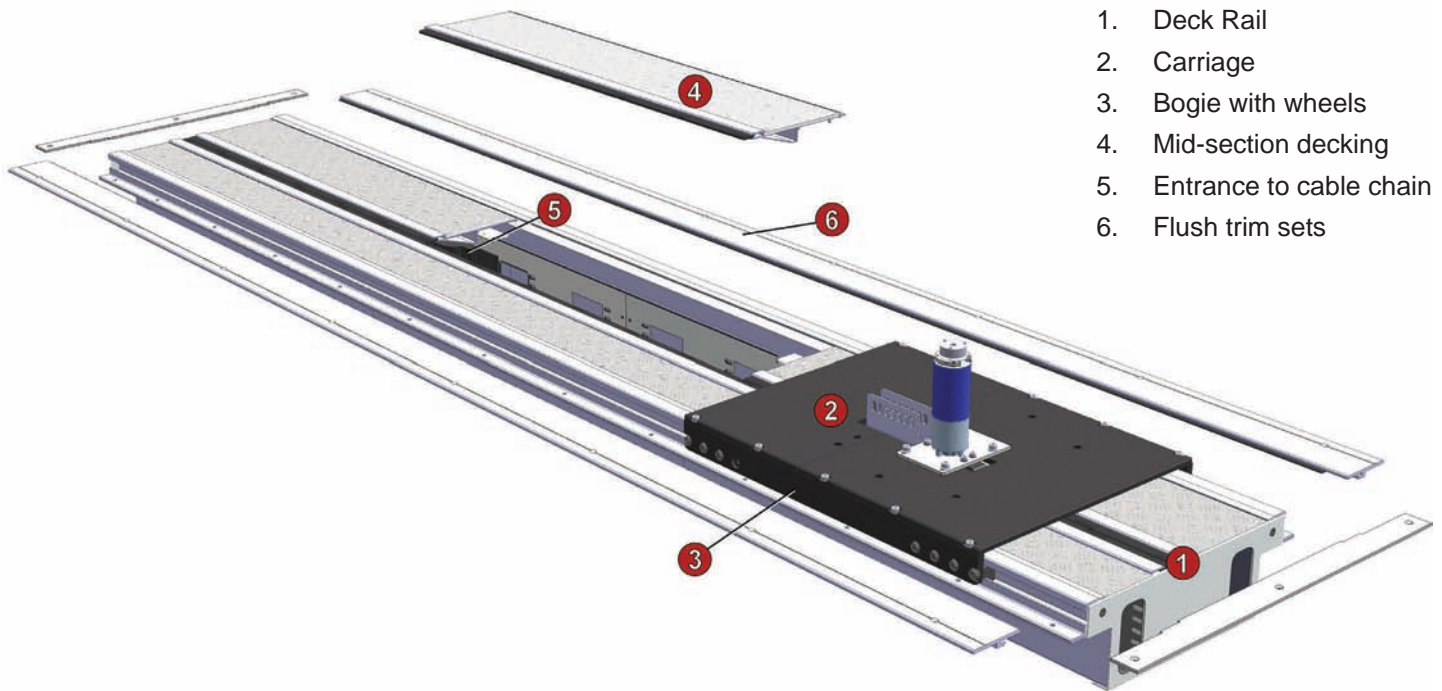

1. Deck Rail
2. Carriage
3. Bogie with wheels
4. Mid-section decking
5. Entrance to cable chain
6. Flush trim sets

Installation:

Note: not all installations will proceed exactly as described here. This is a general guide only.

1. Verify the dimensions of the well and drill holes for the deck rail (pattern A) in the well, being careful to maintain the exact width measurement.
2. If the carriage partially covers the mid decking section (4), connect temporary power to the motor and drive the carriage to one end. Remove the mid-section of the deck rail decking as shown above.
3. Pass the necessary cabling into the access holes in the end/s of the deck rail and secure the deck rail in the well.
4. Thread the necessary cabling into the internal cable-chain and up through the carriage. Confirm that the wheel tracks are completely free of scrap material. Connect power to the deck rail.
5. Replace the decking section in the deck rail. Mount the flush trim sets (6).

Maintenance: Note: Cut power to the deck rail when conducting maintenance. We do not stand liable if alterations are made by cutting or disassembling the deck rails beyond that described here; Any such work will be done at your own risk.

1. When maintenance is required, any or all of the three decking sections of the deck rail may be removed to gain access to the deck rail interior.
2. To gain access to the carriage wheels or stoppers, place firm supports beneath the carriage (wooden wedges work well) and unscrew a bogie (3) on one side so that it can be fully removed with wheels attached. If both bogies need to be removed, support the carriage firmly on both sides (4 points).
3. Do not apply grease in the wheel tracks. Grease will attract dust and other contaminants.

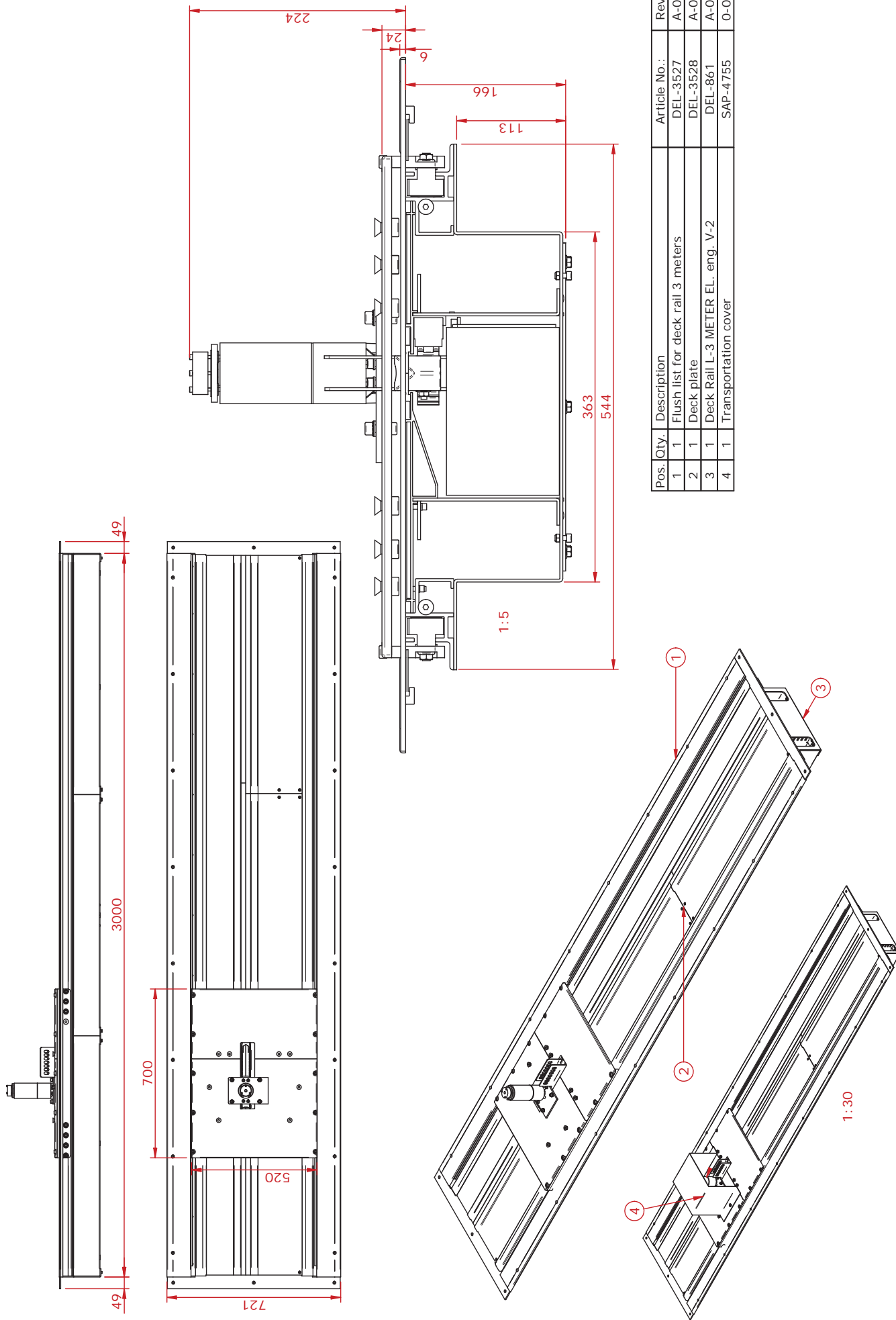

Pos.	Qty.	Description	Article No.:	Rev.
1	1	Flush list for deck rail 3 meters	DEL-3527	A-01
2	1	Deck plate	DEL-3528	A-01
3	1	Deck Rail L-3 METER EL. eng. V-2	DEL-861	A-01
4	1	Transportation cover	SAP-4755	O-01

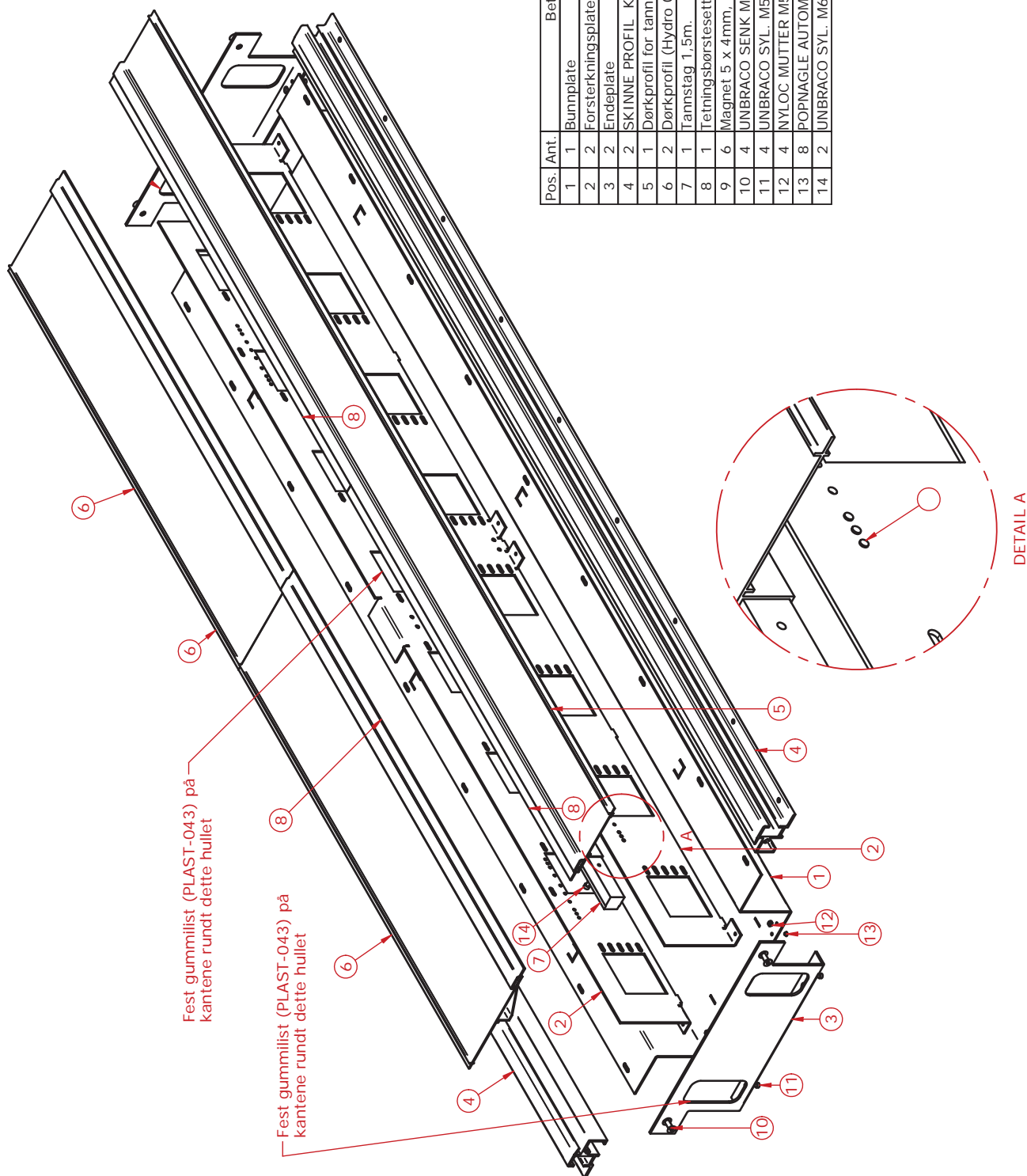

Pos.	Ant.	Betegnelse	Artikkel	Rev.
1	1	Bunnplate	Sap-5003-2000.psm	01
2	2	Forsterkningsplate	Sap-5005-2000.psm	01
3	2	Endeplate	SAP-4014.psm	0-01
4	2	SKINNE PROFIL KL=1992mm	Sap-0268-1992.par	01
5	1	Dørkprofil for tannstang (Hydro5225)	SAP-5004-2000.par	01
6	2	Dørkprofil (Hydro 0158)	SAP-7055.par	01
7	1	Tannstag 1,5m.	Sap-5077-1500.par	01
8	1	Tetningsbørstesett til MX 2,0m.	DEL-3772-2000.asm	01
9	6	Magnet 5 x 4mm, Permanent SMC05	ELDEL-036B.par	0-01
10	4	UNBRACO SENK M8X20 DIN 7991	B420-M8x20.par	
11	4	UNBRACO SYL. M5x12 DIN 912	B415-M5x12.par	
12	4	NYLOC MUTTER M5	B462-M5.par	
13	8	POPNAGLE AUTOMATMAS. 4,8x12,5	POP-029.par	
14	2	UNBRACO SYL. M6x25	B415-M6x25.par	

6675-2500

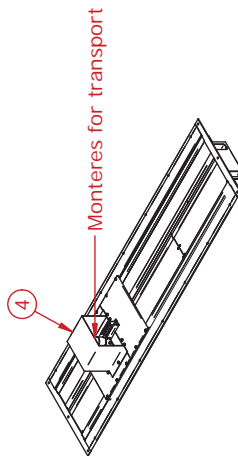
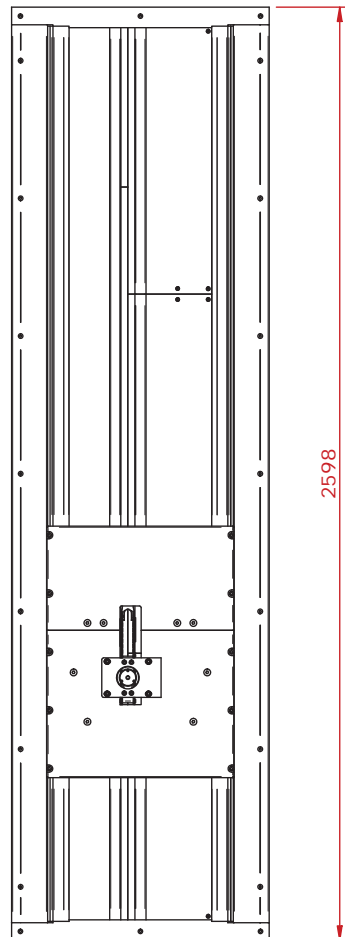
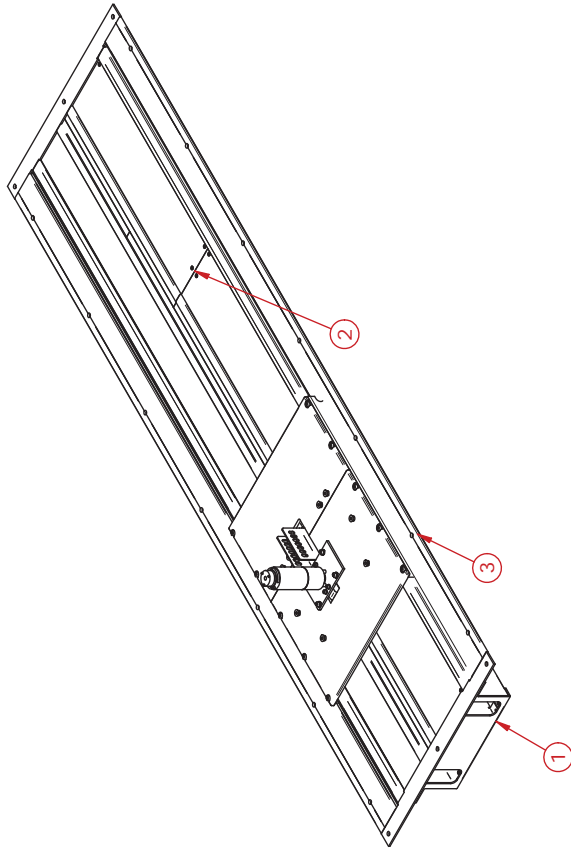
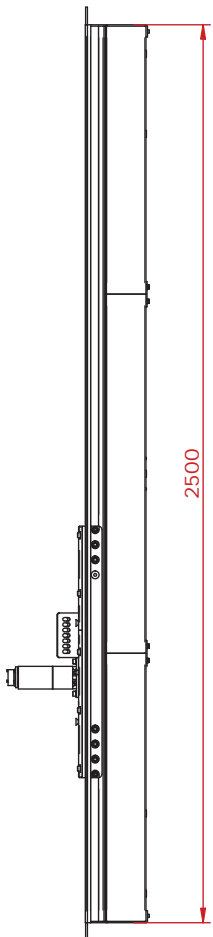
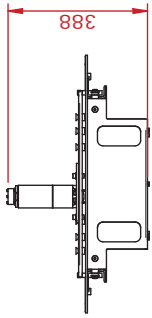

Pos.	Ant.	Vare Navn	Vare Nr.	Rev.
1	1	Dørskinn L-2,5 M. med el.motor V-2	DEL-861-2500	A-01
2	1	Dørplater	DEL-3528-2500	A-01
3	1	Flushlist til 2,5 m skinne	DEL-3527-2500	A-01
4	1	TRANSPORT DEKSEL MX DØRSKINN	SAP-4755	0-01

DEL-864-2500

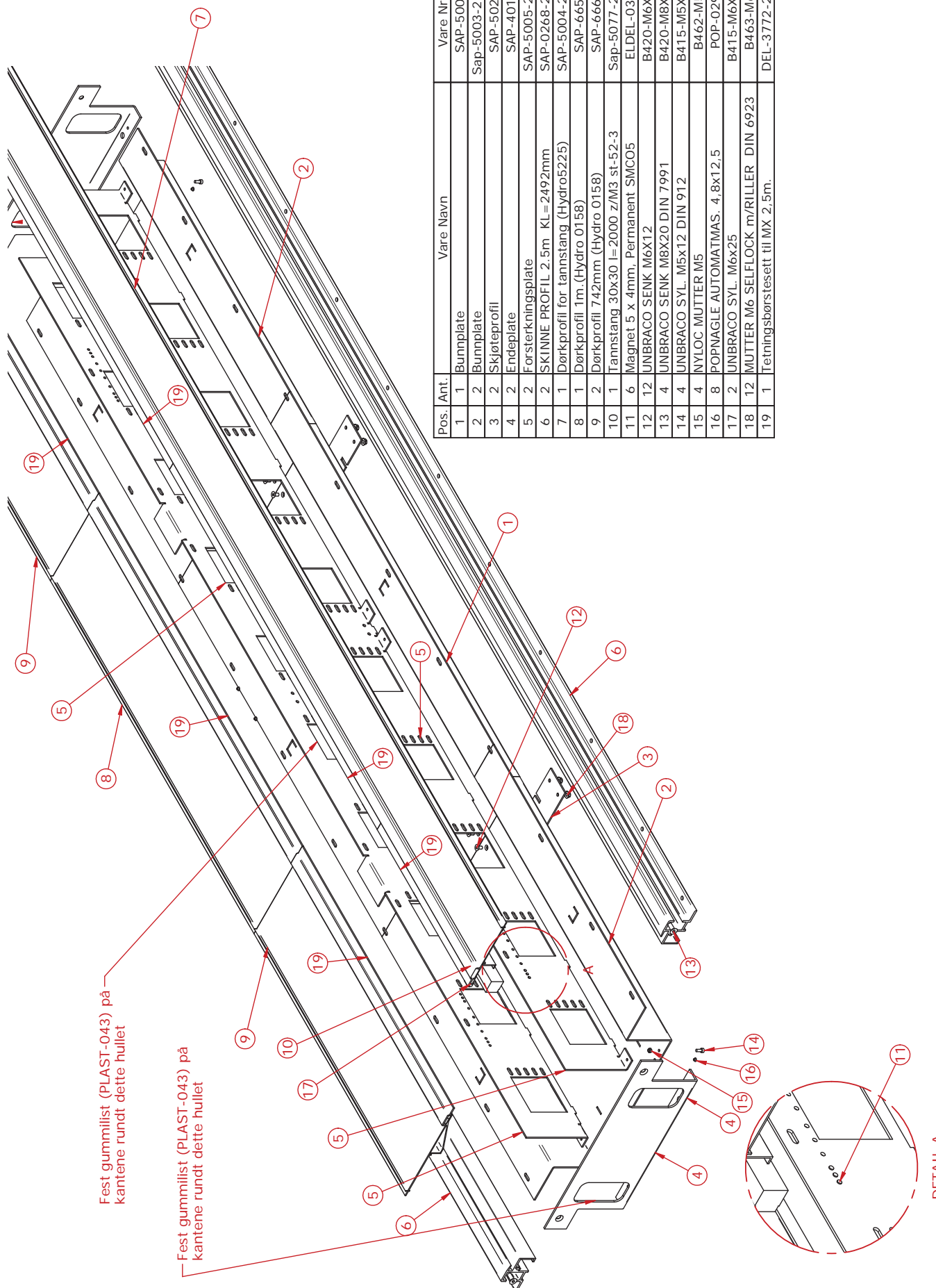

Pos.	Ant.	Vare Navn	Vare Nr.	Rev.
1	1	Bunnplate	SAP-5003	0-01
2	2	Bunnplate	Sap-5003-2500B	0-01
3	2	Skjøteprofil	SAP-5028	0-01
4	2	Endeplate	SAP-4014	0-01
5	2	Forsterkningsplate	SAP-5005-2500	0-03
6	2	SKINNE PROFIL 2.5m KL=2492mm	SAP-0268-2492	0-01
7	1	Dørkprofil for tannstang (Hydro5225)	SAP-5004-2500	0-01
8	1	Dørkprofil 1m (Hydro 0158)	SAP-6650	0-01
9	2	Dørkprofil 742mm (Hydro 0158)	SAP-6661	0-01
10	1	Tannstang 30x30 l=2000 z/M3 st-52-3	Sap-5077-2000	0-01
11	6	Magnet 5 x 4mm. Permanent SMC05	ELDEL-036B	0-01
12	12	UNBRACO SENK M6X12	B420-M6X12	
13	4	UNBRACO SENK M8X20 DIN 7991	B420-M8X20	
14	4	UNBRACO SYL. M5X12 DIN 912	B415-M5X12	
15	4	NYLOC MUTTER M5	B462-M5	
16	8	POPAGLE AUTOMATMAS. 4,8x12,5	POP-029	
17	2	UNBRACO SYL. M6x25	B415-M6X25	
18	12	MUTTER M6 SELFLOCK m/RILLER DIN 6923	B463-M6	
19	1	Tetningsbørstesett til MX 2,5m.	DEL-3772-2500	A-01

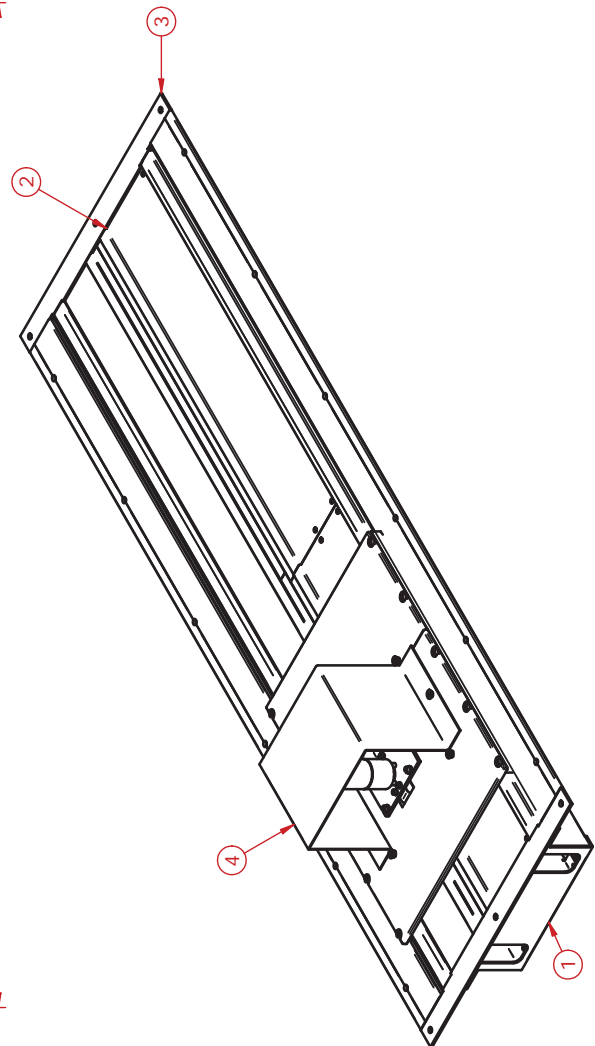
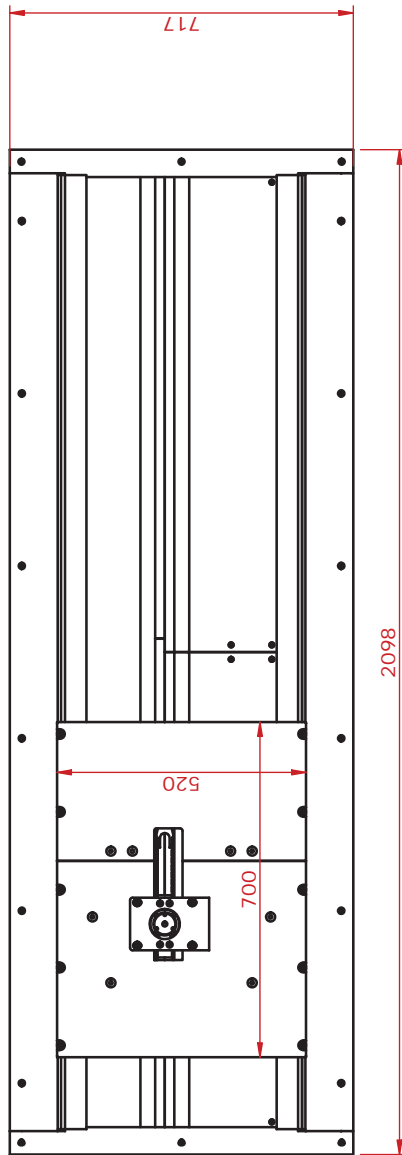
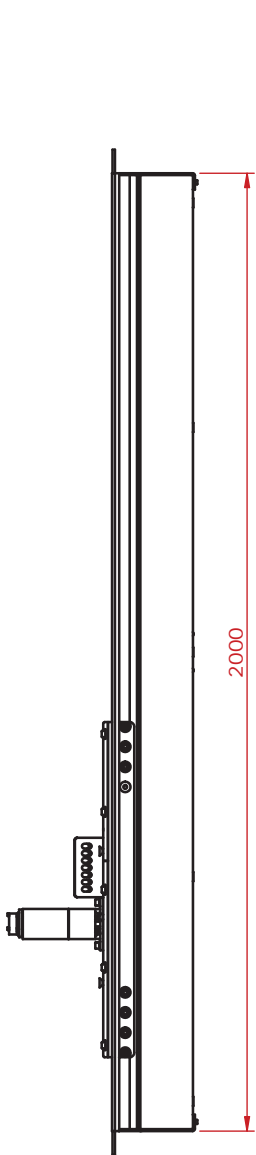
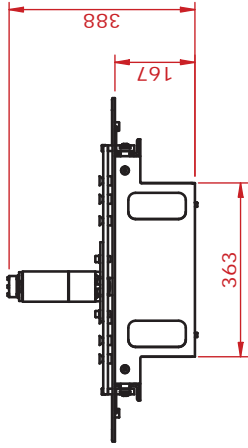

Pos.	Ant.	Betegnelse	Artikkel	Rev.
1	1	Dørskinne L-2,0 M. med el.motor V-2	DEL-861-2000.asm	01
2	1	Dørkplater	DEL-3528-2000.asm	01
3	1	Flushlist til 2m skinne	DEL-3527-2000.asm	01
4	1	TRANSPORT DEKSEL MX DØRSKINNE	SAP-4755.psm	0-01

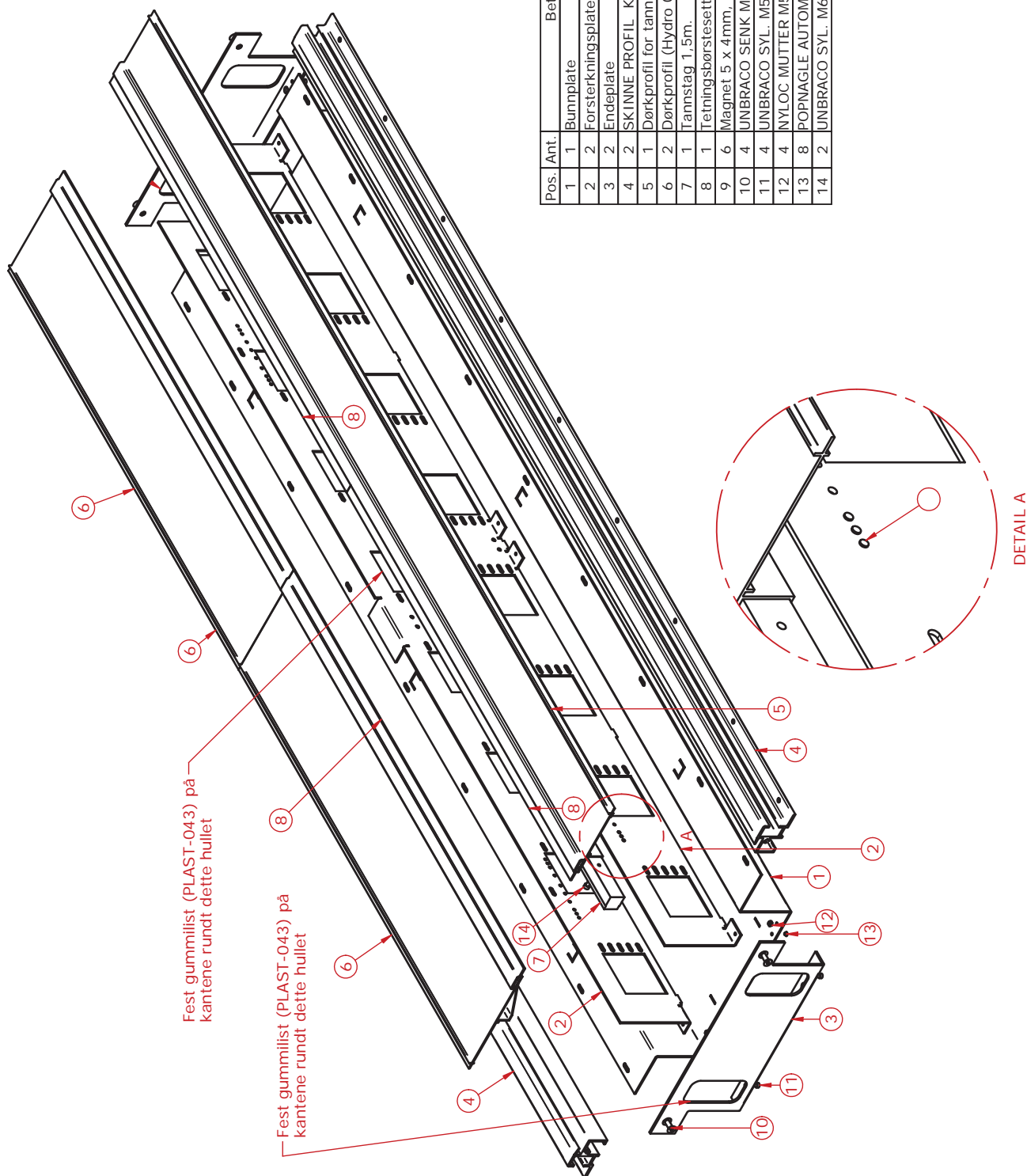

Pos.	Ant.	Betegnelse	Artikkel	Rev.
1	1	Bunnplate	Sap-5003-2000.psm	01
2	2	Forsterkningsplate	Sap-5005-2000.psm	01
3	2	Endeplate	SAP-4014.psm	0-01
4	2	SKINNE PROFIL KL= 1992mm	Sap-0268-1992.par	01
5	1	Dørkprofil for tannstang (Hydro5225)	SAP-5004-2000.par	01
6	2	Dørkprofil (Hydro 0158)	SAP-7055.par	01
7	1	Tannstag 1,5m.	Sap-5077-1500.par	01
8	1	Tetningsbørstesett til MX 2,0m.	DEL-3772-2000.asm	01
9	6	Magnet 5 x 4mm, Permanent SMC05	ELDEL-036B.par	0-01
10	4	UNBRACO SENK M8X20 DIN 7991	B420-M8x20.par	
11	4	UNBRACO SYL. M5x12 DIN 912	B415-M5x12.par	
12	4	NYLOC MUTTER M5	B462-M5.par	
13	8	POPNAGLE AUTOMATMAS. 4,8x12,5	POP-029.par	
14	2	UNBRACO SYL. M6x25	B415-M6x25.par	

DEL-863

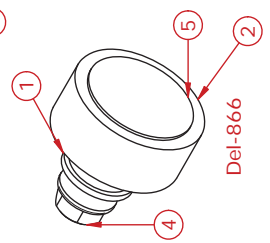
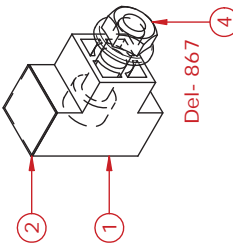
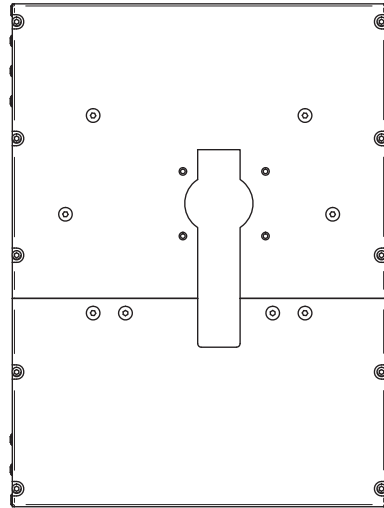
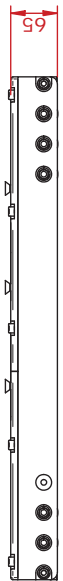
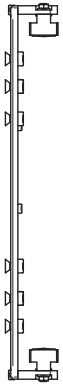
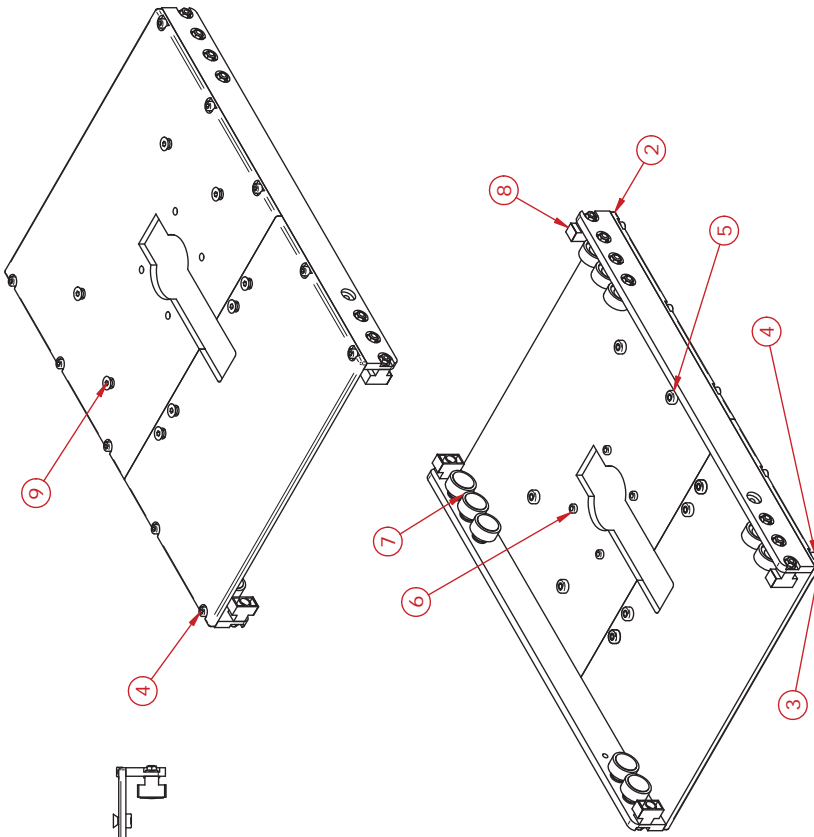

Pos.	Qty.	Description	Article No.:	Rev.
1*	2	Side member MX carrier	SAP-2848	0-03
2	1	Main plate for MX carrier	Sap-2849	0-01
3	1	Aft main plate for MX carrier	Sap-2981	0-01
4	10	UNBRACO SYL. M8x20 DIN 912	B415-M8X20	
5	10	Nut M10 FOR 6mm PLATE	B371-M10-6	
6	4	Screw M8 FOR 5MM PL	B370-M8-5	
7	10	Wheel	Del-866	A-01
8	4	Stop box	Del-867	A-01
9	8	UNBRACO countersunk M10X25 DIN 7991	B420-M10X25	

Pos.	Ant.	Description	Article No.:	Rev.
1	1	BØRSTEKLOSS	MP163	0-01
2	1	FILT 19x19mm	TAPE-002A	0-1
3*	1	UNBRACO SYL.screw M8x25	B415-M8X25	
4	1	Nut M8 SELFLOCK DIN 6923	B463-M8	

Pos.	Ant.	Description	Article No.:	Rev.
1	1	Axle for ball bearing wheel	SAP-0007	0-6
2	1	Rubber coated wheel (Offshore)	KLA-006	
3*	1	UNBRACO countersunk MBX40	B420-MBX40	
4	1	Nut M8 SELFLOCK DIN 6923	B463-M8	
5	1	Lid BR=6MM	MP164	0-1

DEL-870

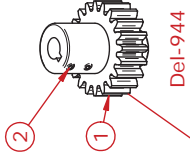

Pos.	Qty.	Description	Article No.:	Rev.
1	1	Gear M3 Z-20	Sap-5030	0-05
2	2	UNBRACO U/H M6X8 DIN 913	B424-M6X8	

Pos.	Qty.	Description	Article No.:	Rev.
1	1	Engine mounting plate	Sap-2876	0-01
2	1	Mounting plate	Sap-2863	0-03
3	1	Gear M3 Z-20 TANNHJ-004	Del-944	A-01
4	1	Mounting plate	Del-978	A-01
5	4	UNBRACO countersunk M6X45	B420-M6X45	
6	4	Nut M6 SELFLOCK DIN 6923	B463-M6	
7	1	Side cover	Sap-5025	0-01
8	1	Energychain: Z26.2/45.063 2X Fester: 2610.34	EKJ-005	
9	4	UNBRACO countersunk M5X10	B420-M5X10	
10	2	Plow	SAP-4038	0-01
11	4	Washer M8 DIN125A	B481-M8	
12	4	Star washer M8 DIN 6798	B484-M8	
13	4	UNBRACO SYL. M8x20 DIN 912	B415-M8X20	
14	4	Washer M6 SYREFAST DIN125	B481-M6	
15	4	UNBRACO SYL. M6x25	B415-M6X25	
16	1	Shell	Sap-5079	0-02
17	1	Mounting plate for brake	SAP-6554	0-01
18	4	Washer M4(4,3x12x1) DIN9021	B480-M4	
19	4	UNBRACO countersunk M4X10	B420-M4X10	
20	3	UNBRACO SYL. M3x25	B415-M3X25	

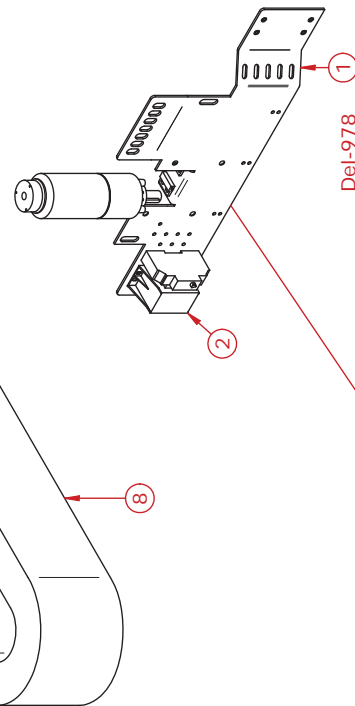
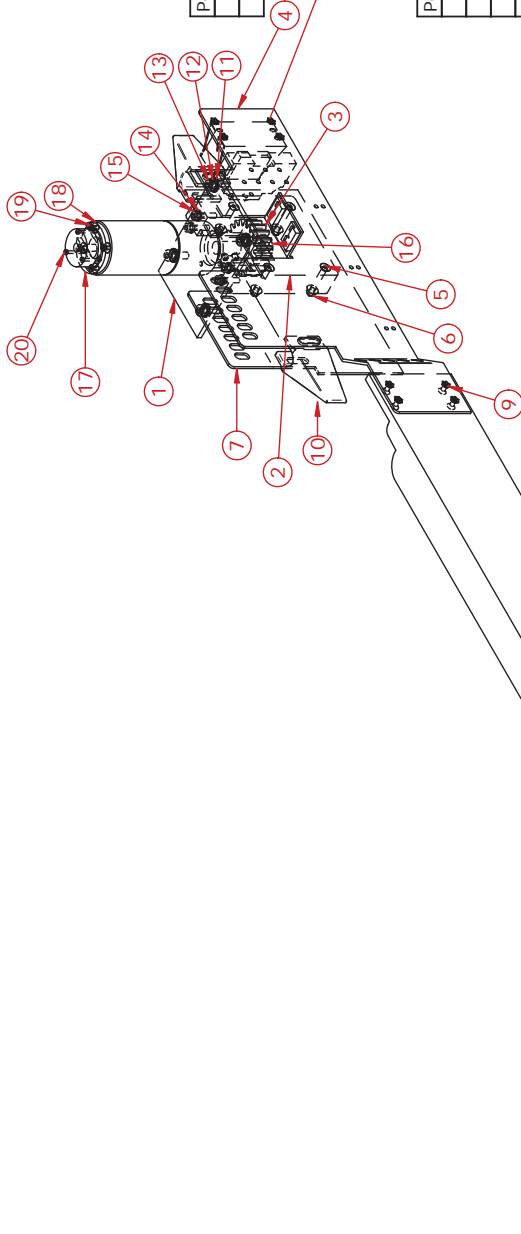

Pos.	Qty.	Description	Article No.:	Rev.
1	1	Mounting plate	DEL-3575	A-01
2	1	Engine and controlling equipment	DEL-3574	A-01

MX Deck Rail Wiring Diagram

24V 20A

BRY-001

